

# QuadroDesign

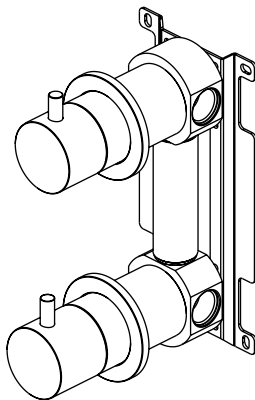

IN047M

**Gruppo incasso termostatico e deviatore a due vie di uscita**

**Built-in thermostatic set with 2 way diverter**

**Thermostatische Einbaugruppe und Zweiwegeumsteller**

**Grupo empotrado termostático e inversor 2 salidas**

**Groupe thermostatique encastré avec inverseur 2 voies**

---

**Istruzioni di montaggio**

**Assembling instructions**

**Installationsanleitung**

**Instructions de montage**

**Instrucciones de montaje**



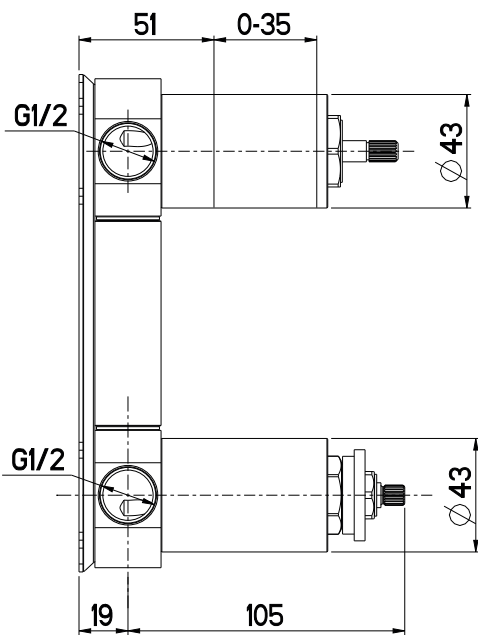
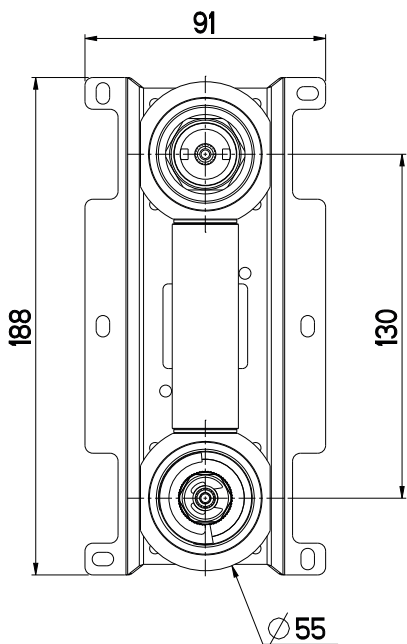

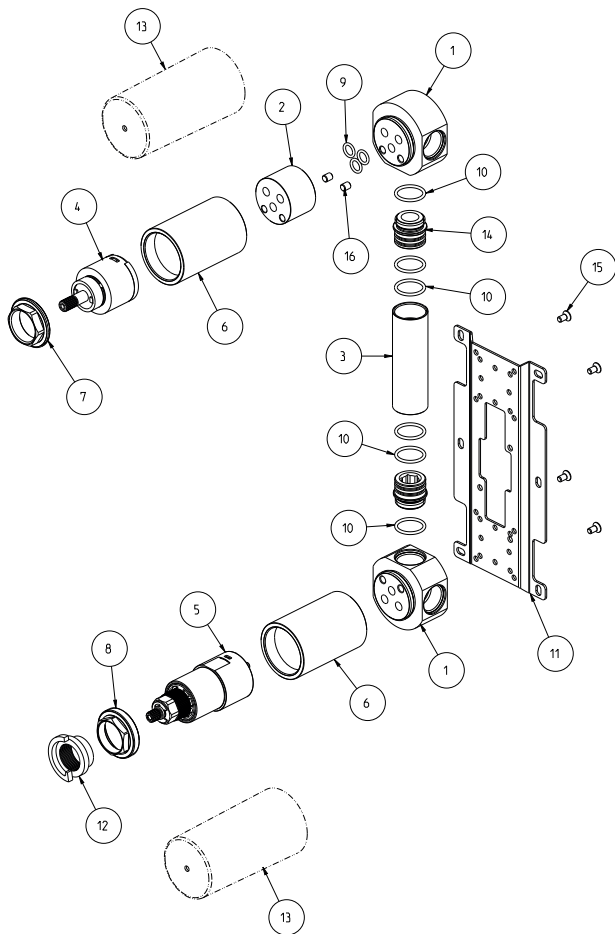

16	VG280	2	GRANO M5x6 UNI5923 A2
15	VG024	4	VITE M4x6 DIN 965 A2
14	RC029	2	RACCORDO GI/2 PORTA MANICOTTO
13	PP1247	2	PROTEZIONE PER CORPI D.43
12	PP043	1	FERMO CARTUCCIA AR AP99150-H (ARC0129)
11	PI009-2	1	STAFFA DI SUPPORTO PER INCASSO
10	OR140	6	OR 18x2
9	OR012	3	OR 7,65x1,78
8	GH382	1	GHIERA SERRAGGIO M37x15 PER TERMOSTATICA
7	GH101	1	GHIERA SERRAGGIO M37x15
6	GH090	2	BICCHIERE PROLUNGATO PORTA CART. D.43
5	CR382	1	CARTUCCIA TERMOSTATICA D.35 (AP99150-H)
4	CR308	1	CARTUCCIA DEVIATRICE KDZ-35A
3	CN102	1	MANICOTTO DI COLLEGAMENTO
2	AC242	1	BASE PROLUNGA INC. H.25 CARTUCCIA 35MM
1	AC204	2	CORPO MISCELATORE INCASSO
	CODICE	QTA	DESCRIZIONE

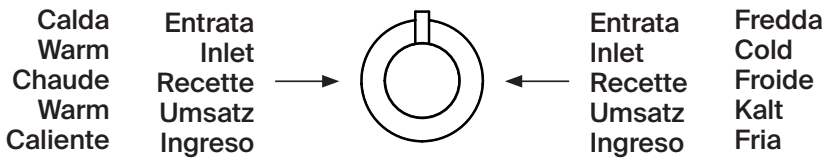
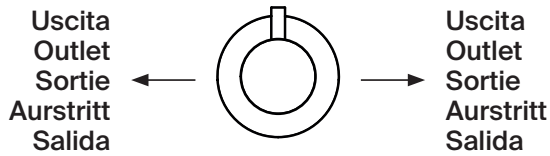

Mettere in pressione l'impianto per verificarne la tenuta e la corretta installazione.

Put the system under pressure in order to verify the hold and correct installation.

L'installation sous pression pour en vérifier l'étanchéité et le bon fonctionnement.

Installation unter Druck stellen um das Fassungsvermögen und den korrekten Einbau zu überprüfen.

Presurizar la planta para comprobar su retención instalación correcta.

---

**Profondità Massima**  
**Maximum Depth**  
**Profondeur Maximale**  
**Maximale Tiefe**  
**Profundidad Máxima**

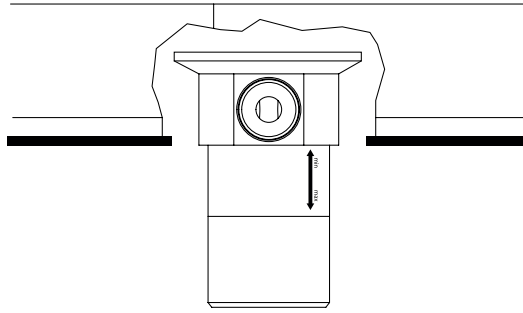

**Profondità Massima**  
**Maximum Depth**  
**Profondeur Maximale**  
**Maximale Tiefe**  
**Profundidad Máxima**

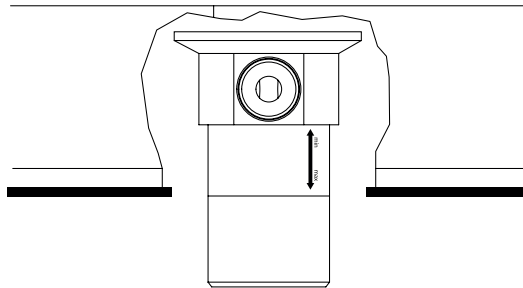

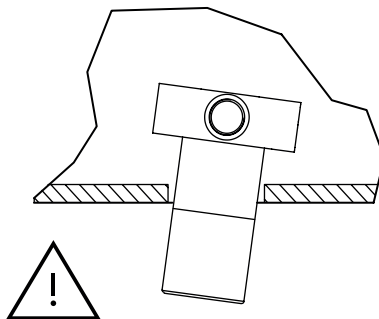
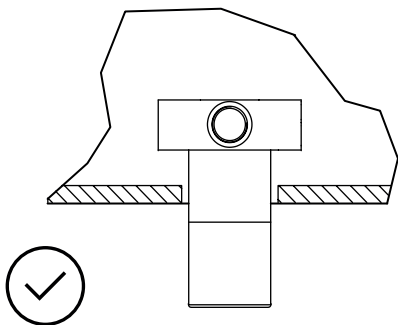
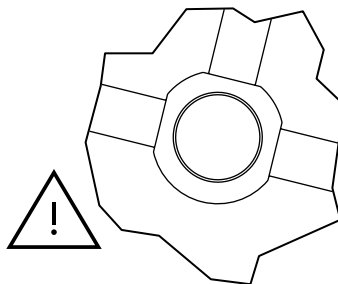
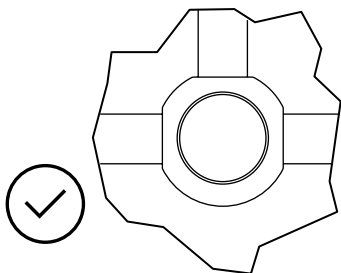

Con l'ausilio di una livella posizionare correttamente il corpo incasso sia in orizzontale che in verticale seguendo le specifiche delle figure seguenti prestando particolare attenzione alla profondità d'incasso minima e massima riportate sul cappuccio di protezione in plastica nera.

With the help of a level, correctly position the built-in body both horizontally and vertically according to the specifications of the following indications, paying particular attention to the minimum and maximum mounting depth information on the protective black pastic covering.

Mithilfe einer Wasserwaage den Einbaukörper sowohl horizontal als auch vertikal korrekt positionieren und hierbei die nachfolgenden spezifischen Abbildungen befolgen. Unbedingt die auf den Etiketten der Schutzvorrichtungen ersichtliche minimale und maximale Einbautiefe einhalten.

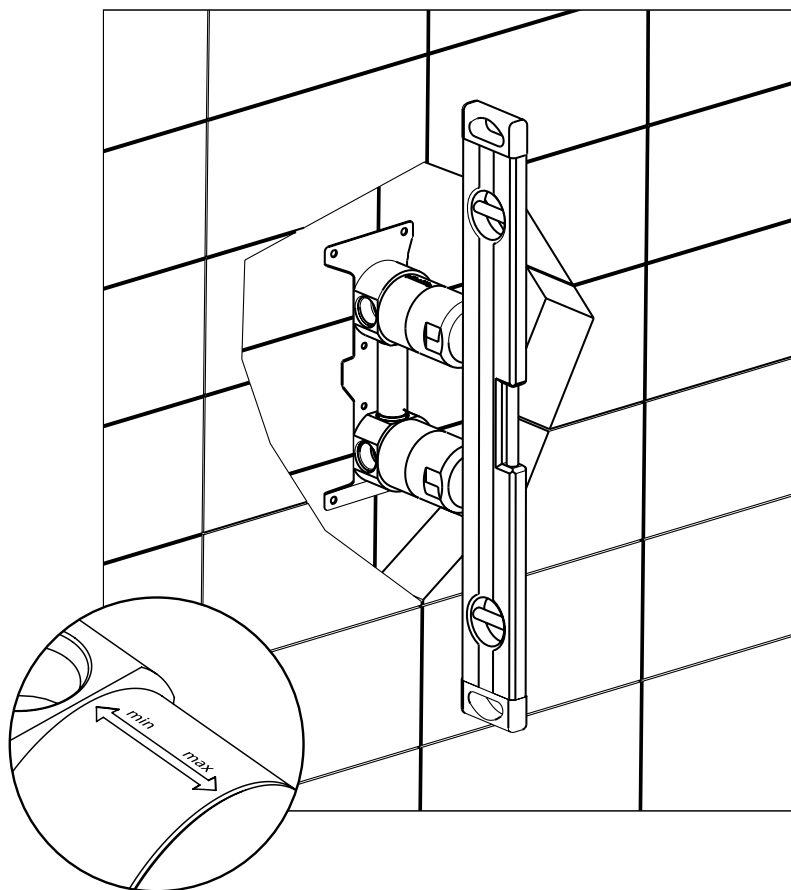

Con la ayuda de un nivel, posicionar correctamente el cuerpo a empotrar de manera horizontal y vertical siguiendo las indicaciones de las figuras a continuación prestando especial atención a la profundidad del empotrado mínimo y máximo indicada en las etiquetas ubicadas en la protección en plastica.

À l'aide d'un niveau, placer correctement le corps à encastrier aussi bien à l'horizontale qu'à la verticale en suivant les caractéristiques des figures ci-dessous et en prêtant attention à la profondeur d'encastrement minimum et maximum indiquées sur la protection noire.

---

**Manopola deviatore.  
Diverter handle.**

Source

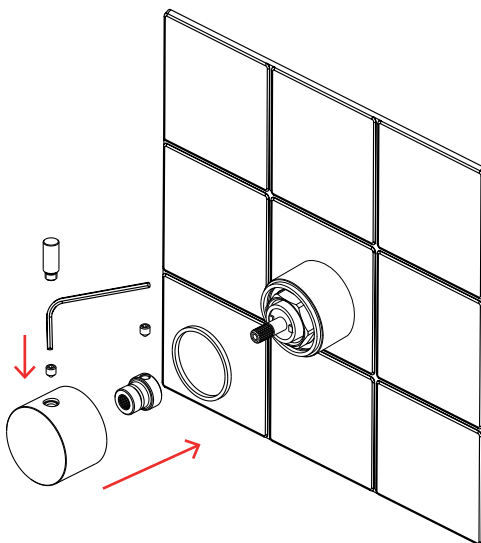

Modo

Stereo

HB

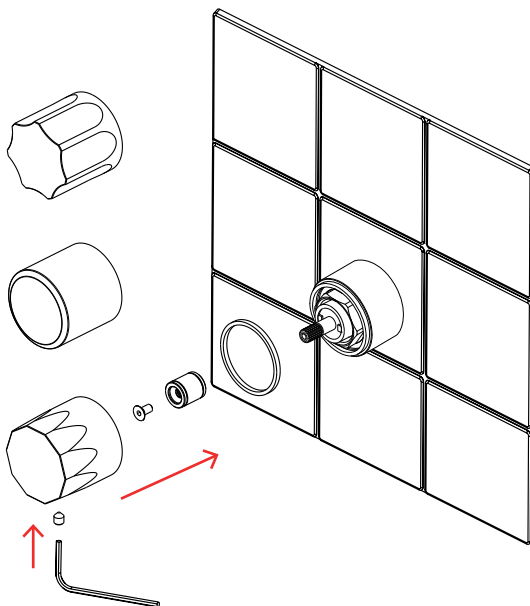

---

**Manopola termostatico.**  
**Thermostatic handle.**

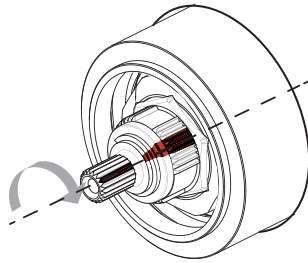

Allineare linee rosse per taratura 38°.  
Align red lines for 38° calibration.  
Rote Linien für 38° Kalibrierung ausrichten.  
Aligner lignes rouges pr l'étalonnage à 38°.  
Alinear líneas rojas para calibración a 38°.

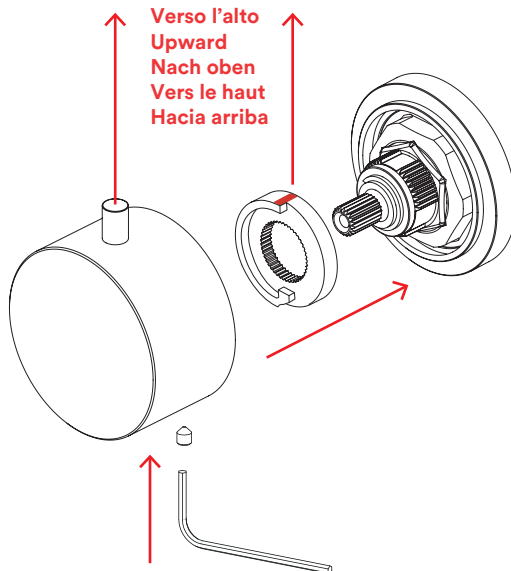



Quadro srl  
via Bonetto 40  
28017 San Maurizio d'Op.  
(NO) Italy  
Tel 0039.0322.96266  
Fax 0039.0322.967264  
info@quadrodesign.it  
www.quadrodesign.it